

- Sleep function - How to easily go to sleep or rest mode?

Omni	
Global	
Sip and Puff	
External On/Off Switch Detect	Off
Scan Speed	1.0 s
Scan Freeze in Mode	[]
Sleep 12V	On

Method A:

1. Long press on the User Switch sensor to access the User Menu.
2. Navigate through the User Menu using the forward/gas pedal sensor to highlight **Sleep**. Press right on the head array to enter.
3. The sleep symbol appears on screen for a few seconds.
4. The OMNI 2 switches OFF.

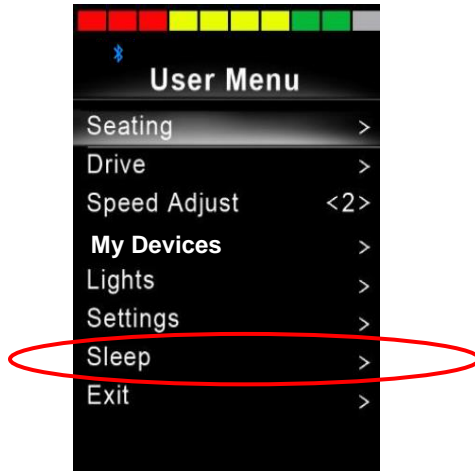
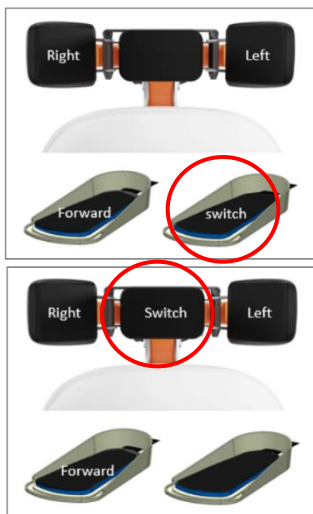

Method B:

1. Long press on the User Switch.

Omni	CoMoveIT Smart IN	CoMoveIT Smart M
Global		
Profiled		
Ports		
SID	Port 1	Port 2
Switches	Port 1	Port 2
User Switch	Normally Open	Normally Open
Switch Detect	Off	Off
9-Way Detect	Off	Off
Switch Long	0.00 s	1.00 s
Switch Medium	1.25 s	1.00 s
Switch Debounce	50 ms	50 ms
Double Click	0.0 s	0.3 s
User Switch Detect	Off	Off
9-Way SID Switch Detect	Off	Off

Omni	CoMoveIT Smart IN	CoMoveIT Smart M
Global		
Profiled		
Ports		
SID	Port 1	Port 2
Switches	Port 1	Port 2
User Switch	Normally Open	Normally Open
Switch Detect	Off	Off
9-Way Detect	Off	Off
Switch Long	3.00 s	1.00 s
Switch Medium	1.25 s	1.00 s
Switch Debounce	50 ms	50 ms
Double Click	0.0 s	0.3 s
User Switch Detect	Off	Off
9-Way SID Switch Detect	Off	Off

Switch Long Time: >Switch Medium and up to 5 s, with 0.25 s intervals.

Wake up from sleep.

1. Press on the User Switch sensor to wake up OMNI 2.
2. The OMNI 2 switches ON.

